

HONDA

EC2000 – EC3600 – EC5000 – ECT7000

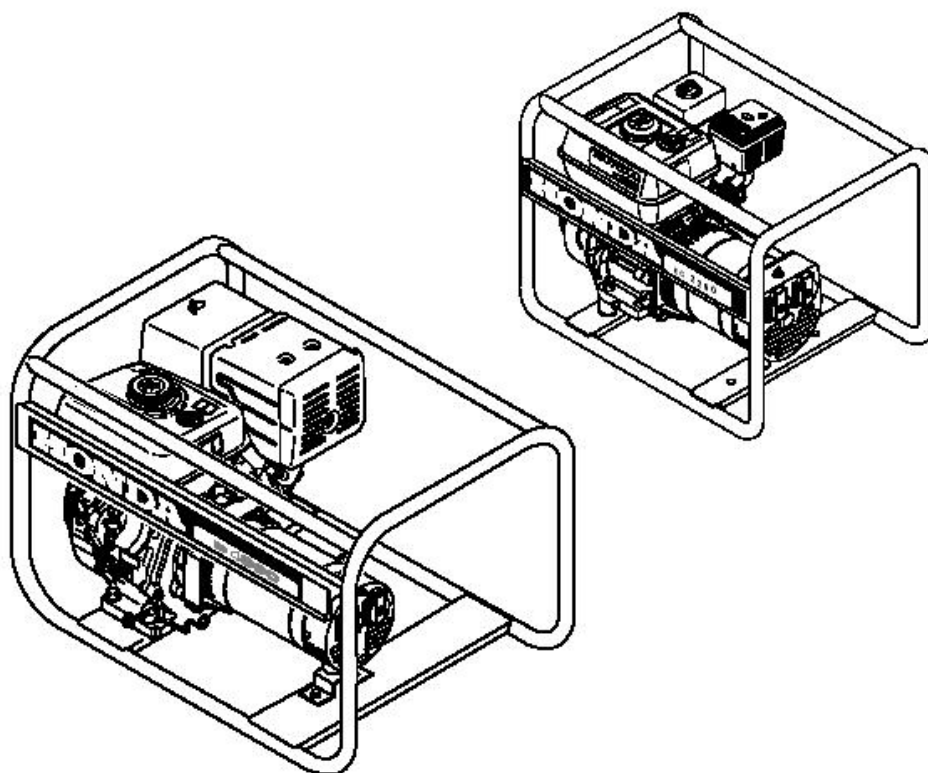

ВНОСИТЕЛ:

„Премиум Мотор“ ООД
СОФИЯ,
бул. Андрей Ляпчев № 34
тел. 02/ 4235879

!

I.	2	.
1.	2	.
2.	3	.
II.	5	.
III.	8	.
1.	8	.
2.	9	.
IV.	10	.
1.	10	.
2.	11	.
3.	11	.
4.	11	.
5.	12	.
6.		
7.	13	.
	14	.
V.	15	.
1.	15	.
2.	15	.
3.	16	.
4.	17	.
5.	17	.
VI.	19	.
1.	19	.
2.	19	.
VII.	20	.
VIII.	21	.

I. _____

“ ! ”

“ ”

“ ”



1.

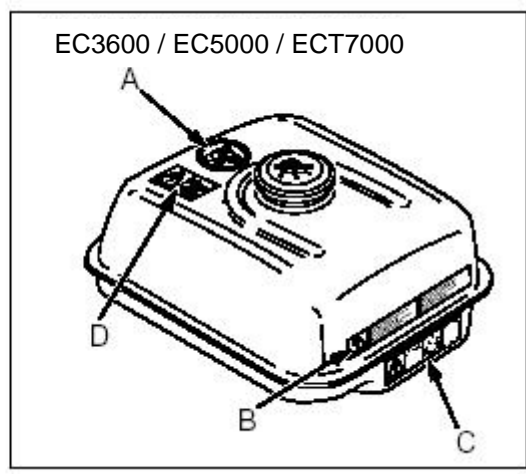
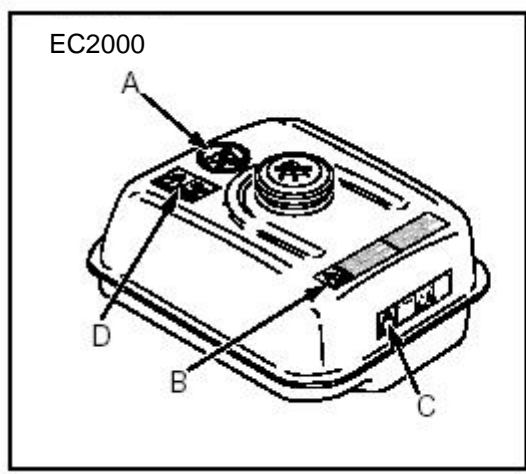

B

	SE STOP THE ENGINE BEFORE REFUELING.	P DESLIGUE O MOTOR ANTES DE ABASTECER.
	F ARRETEZ LE MOTEUR AVANT DE REFAIRE LE PLEIN.	SP STÅNG AV MOTORN FÖRE BRÄSLEPÅFYLLNING.
	D VOR AUF TANKEN MOTOR ABSTELLEN.	S STÅNG AV MOTORN FÖRE BRÄSLEPÅFYLLNING.
	I ARRESTARE IL MOTORE PRIMA DI FARE RIFORMIMENTO.	SK STOP MOTOREN FÖR BRÄNDSTOFFPÅFYLLNING.
	NL STOP DE MOTEUR ALVORENS BIJ TE TANKEN.	N SLÅ AV MOTOREN FÖR PÅFYLLING.
	E PARE EL MOTOR ANTES DE REPOSTER.	SP SMMMUTA MOOTTORI ENNEN TANKKAUSTA.

C

				:
				:
				:

D

		:
--	--	---

2.

	HONDA EUROPE POWER EQUIPMENT S.A.				
	RUE DES CHATAIGNIERS - PÔLE 45 ← 9				
3	45140 ORMES FRANCE				
	CE	EZ ← 8	← 7		
99	199 ← 6	← 5			
	kW	min ⁻¹	kg		

- 1.
 - 2.
 - 3.
 - 4.
 - 5.
 - 6.
 - 7.
 - 8.
 - 9.
- EEC/84/536
/89/392
- kWt
- /

1.

2.

3.

4.

5.

6.

7.

8.

9.

10.

11.

1

II.

2000 GV

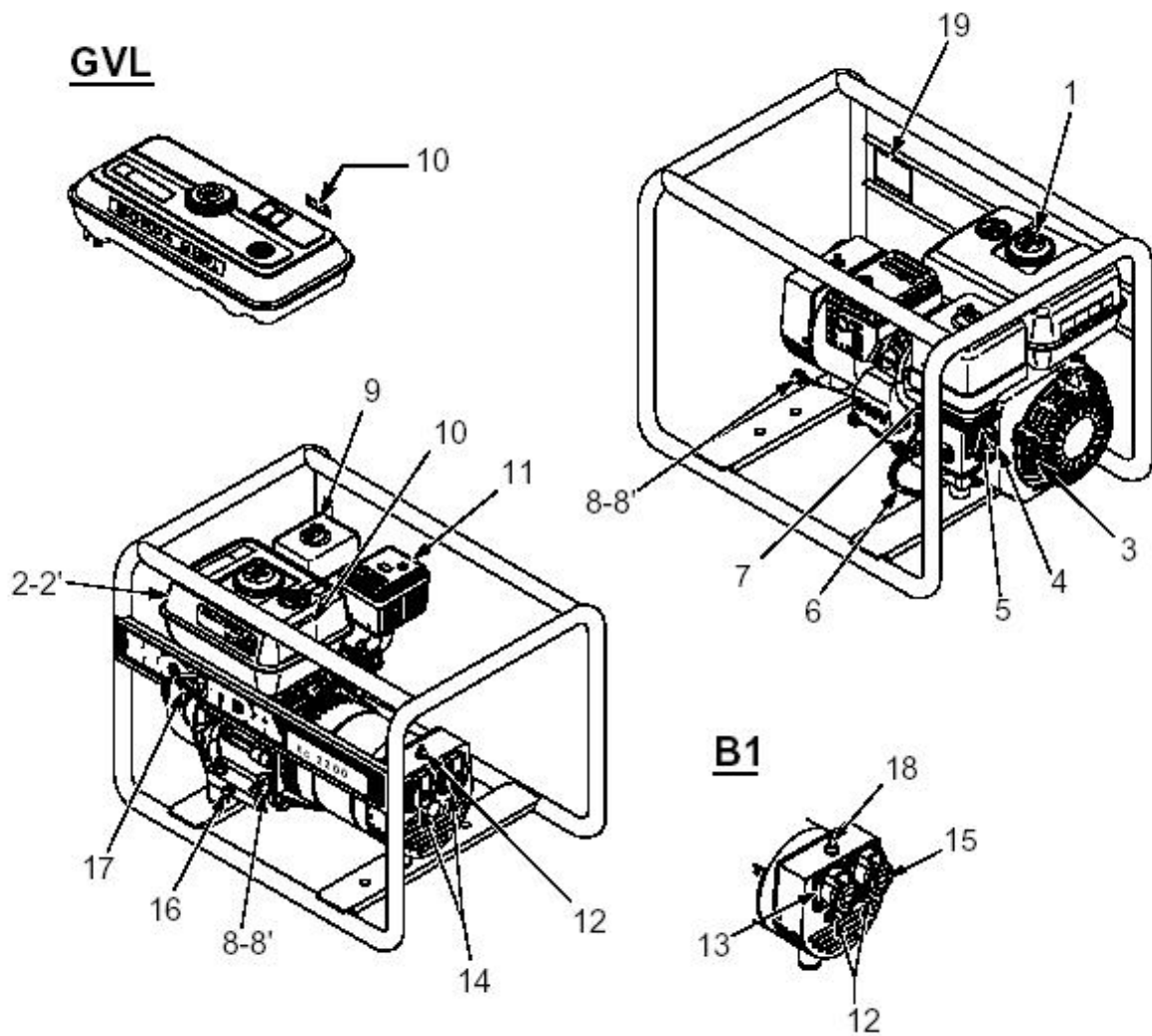

- | | | | |
|-----|-----------|-----|---------------|
| 1. | | 11. | |
| 2. | 3,6 L | 12. | |
| 2' | 9 L (GVL) | 13. | 230V/16A () |
| 3. | | 14. | 230V/16A () |
| 4. | | 15. | 115V/16A () |
| 5. | | 16. | |
| 6. | | 17. | |
| 7. | | 18. | |
| 8. | (| 19. | “ ” 115V/230V |
| | 8 8') | | |
| 9. | | | |
| 10. | | | |

3600 GV

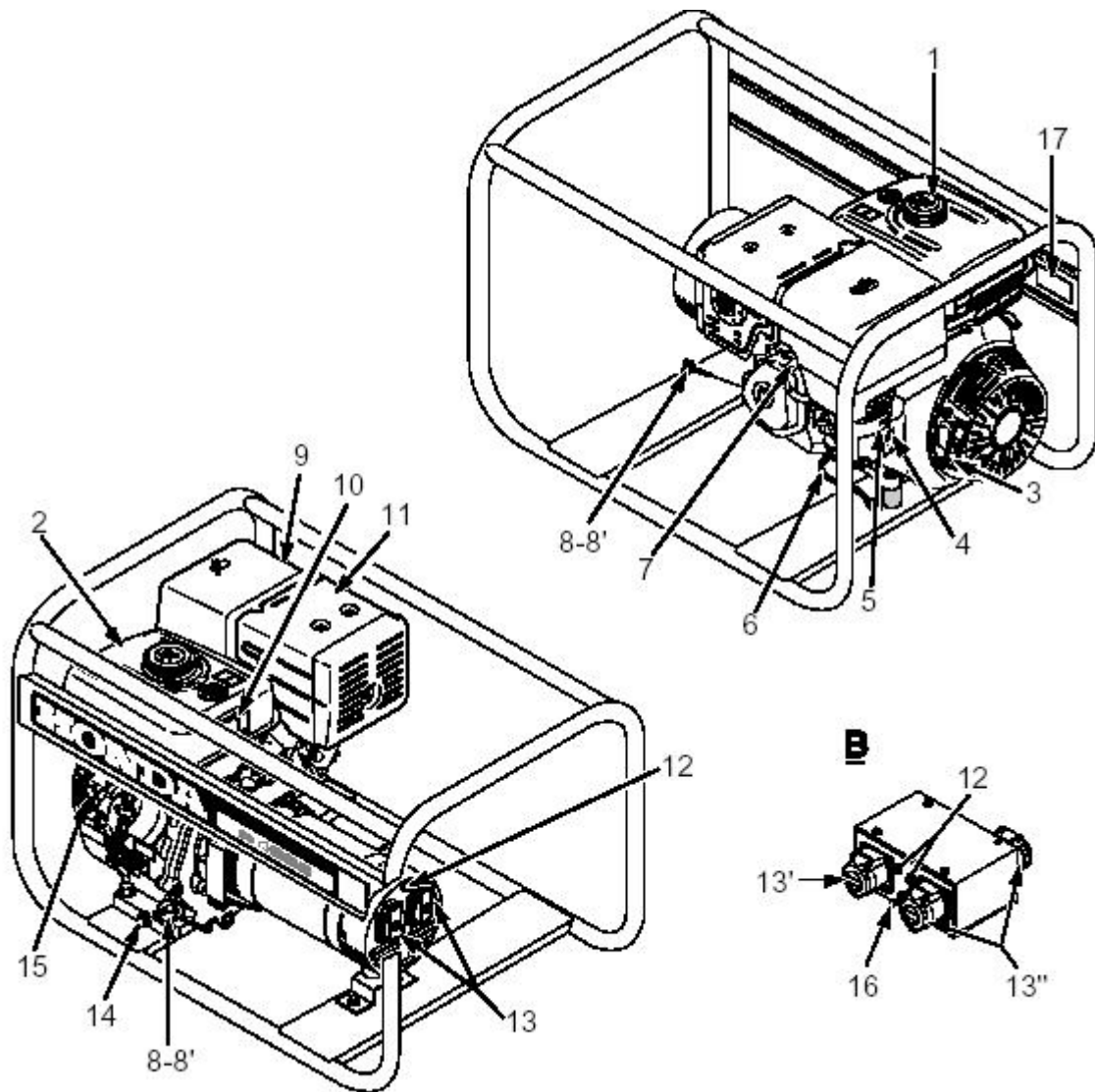

- | | | | |
|-----|-------|------|---------------|
| 1. | | 11. | |
| 2. | | 12. | |
| 3. | | 13. | 230V/16A () |
| 4. | | 13' | 230V/16A () |
| 5. | | 13'' | 115V/16A () |
| 6. | | 14. | |
| 7. | | 15. | |
| 8. | | 16. | |
| | 8 8') | | " " 115V/230V |
| 9. | | 17. | |
| 10. | | | |

5000 GV

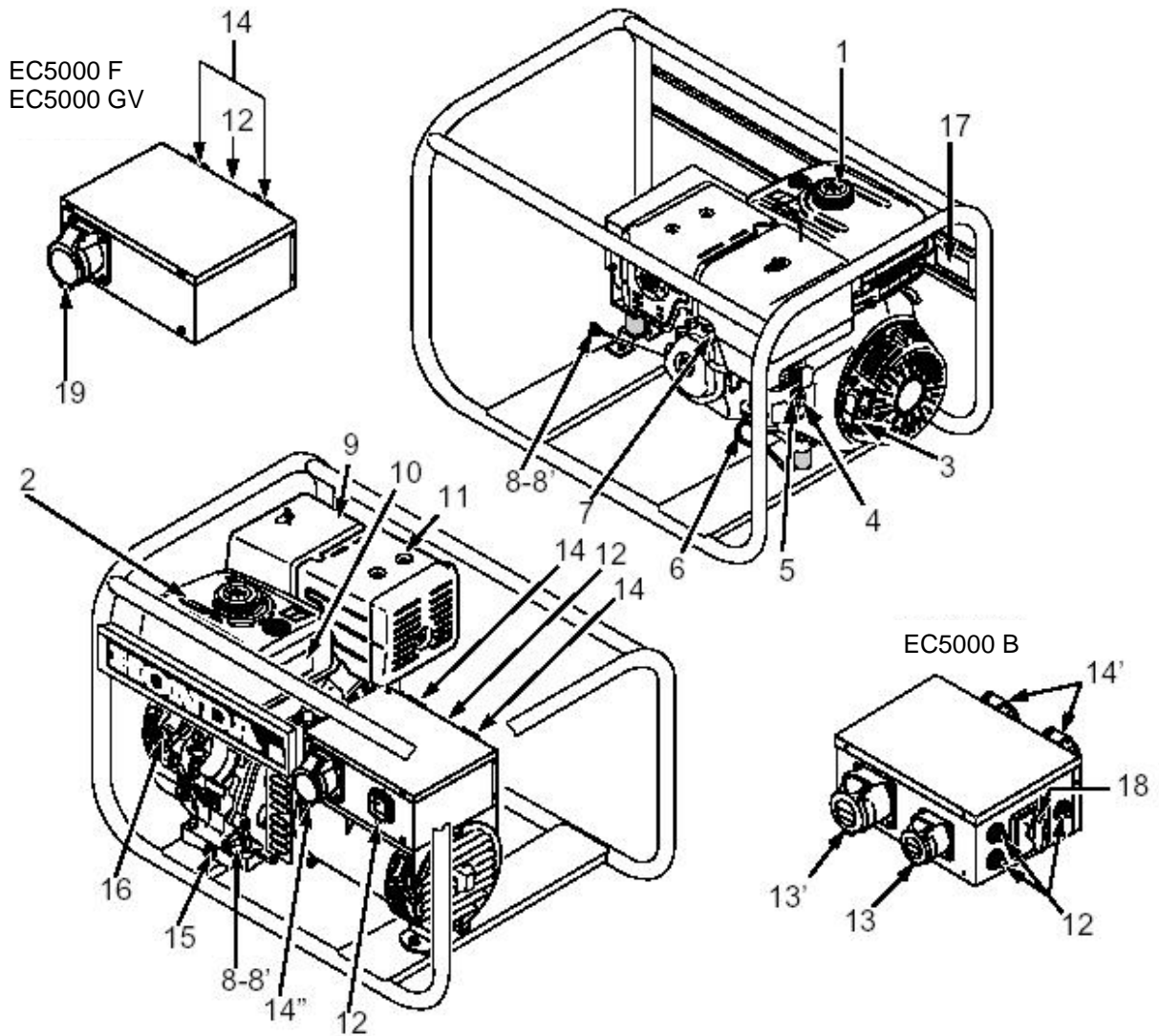

- | | | |
|-----|------|---------------|
| 1. | 13. | 115V/16A () |
| 2. | 13' | 115V/32A () |
| 3. | 14. | 230V/16A () |
| 4. | 14' | 230V/16A () |
| 5. | 14'' | 400V/16A () |
| 6. | 15. | |
| 7. | 16. | |
| 8. | 17. | |
| | | (8 8') |
| 9. | | “ ” 115V/230V |
| 10. | 18. | |
| 11. | 19. | 230V/32A () |
| 12. | | |

III.

!

1.

:

-
-
-

HONDA 4-
SG, SF, CC CD. SAE 10W30

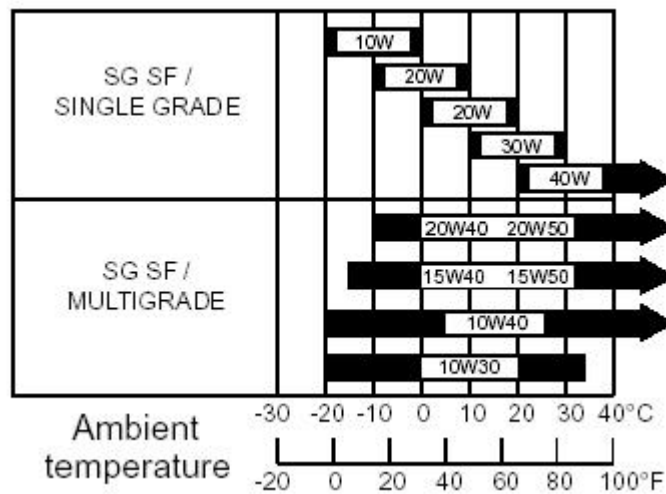

1.

(1)
(2).

2.

3.

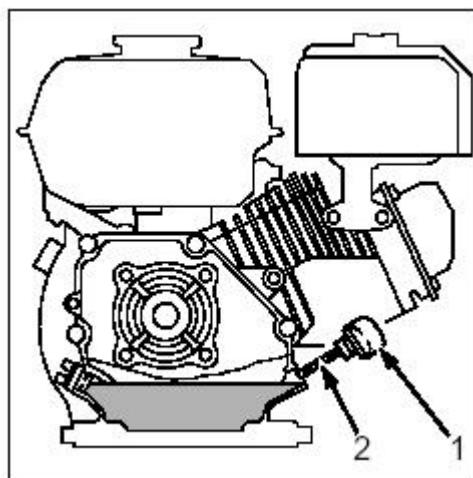

2.



!

.

.

.

:

-
-

-

,

,

.

:

EC2000	3,6 .
EC3600	6 .
EC5000	6,5 .
ECT7000	6,5 .

,

,

.

IV.

1.

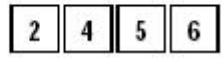

• :
 1. "ON" (1) ("ON"), (2)
 _____ :

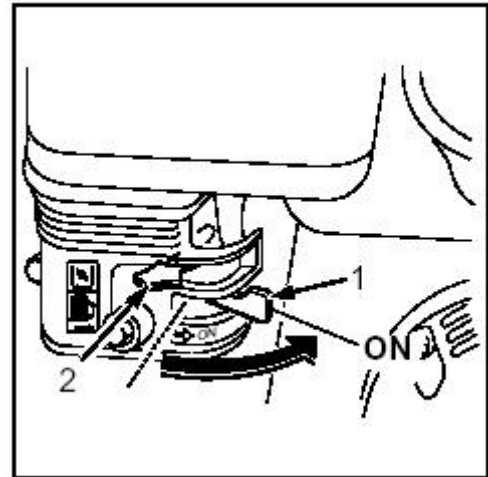

2. "ON"
 3. (4) ,

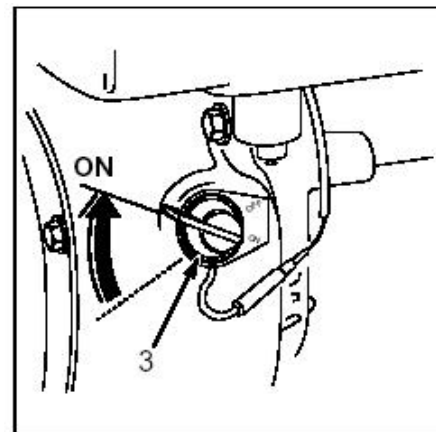
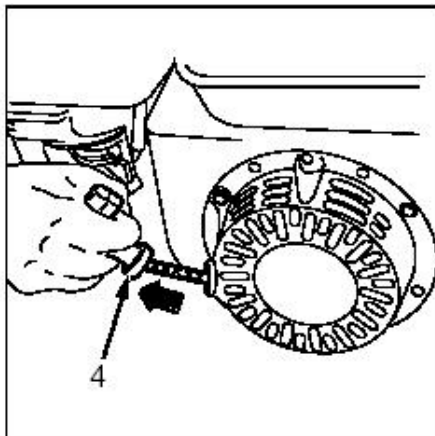

• :
 • -
 • -
 4. (2) ()

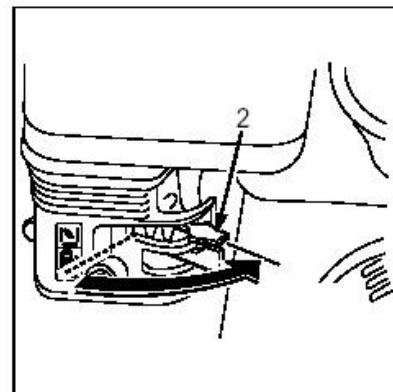

2.

“(ON”)

3.



- 1.
- 2.
- 3.

“(OFF”. (1)

(2)

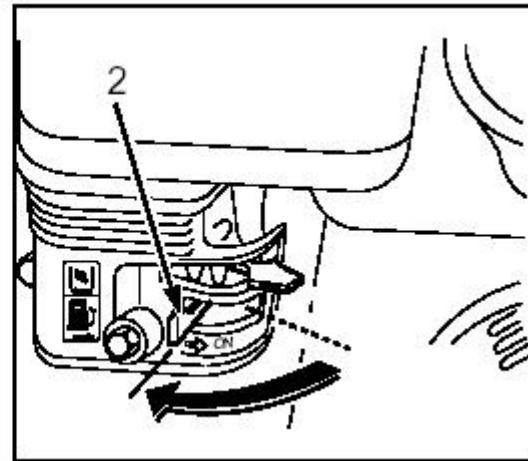
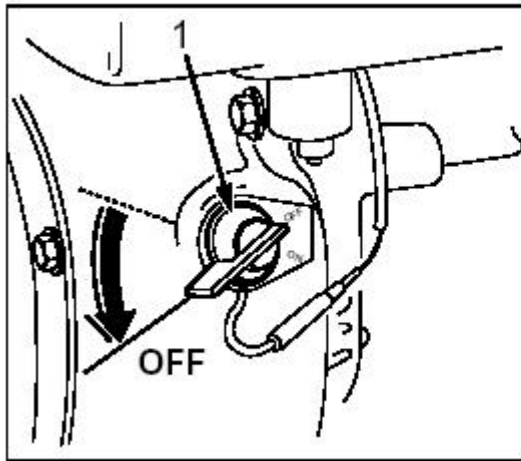

4.

1800

HONDA.

3,5 % 300

HONDA

6.

ECT 7000 (230/400V)

	0	3000 W	4000 W	5000 W	6000 W	7000 W
	4500 W	1300 W	950 W	650 W	300 W	0

HONDA.

7.

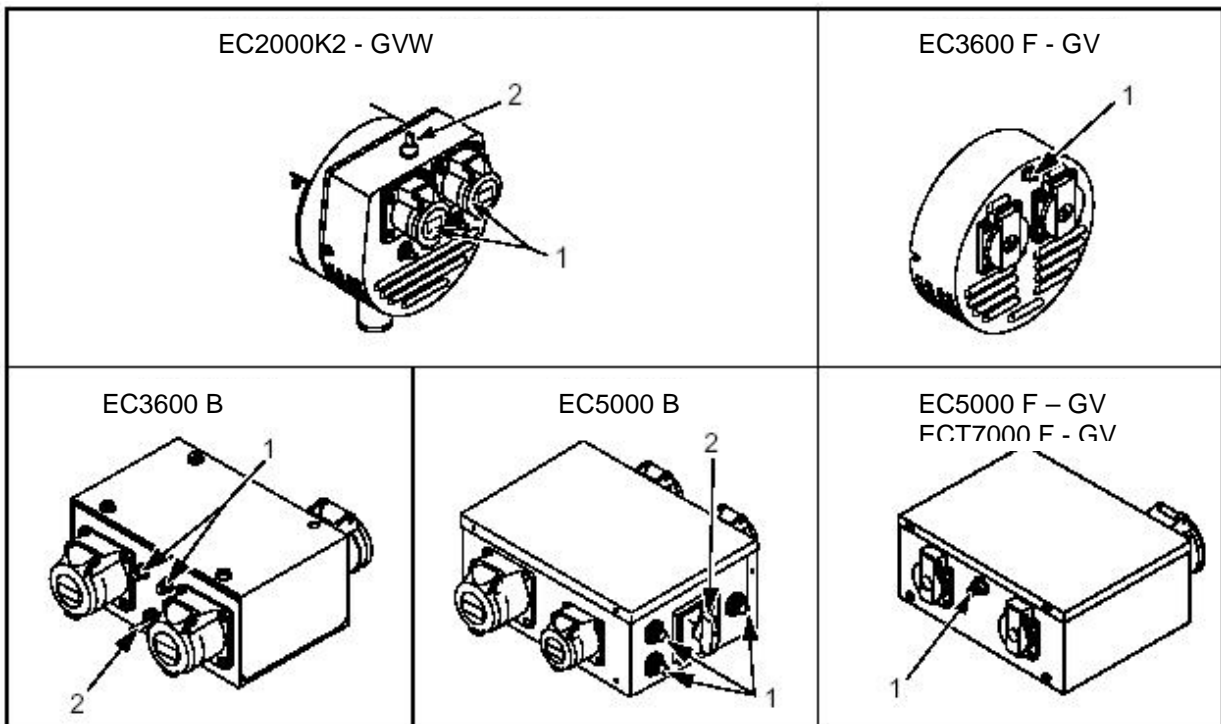

1. B1 – (2)
2. ,
3. .



:

•

15

•

HONDA.

HONDA,

V. _____

1.

			1-	3	6	
			20	50	100	300
				(1)		
						(2)
						(2)
						(2)

_____ :

(1) -

(2) HONDA ,

2.

• :

• .

• .

1. (2) (1).

2. (2) (3)

3. .

• :

EC2000: 0.6 L

EC3600 – EC5000 – ECT7000: 1.1 L

_____:

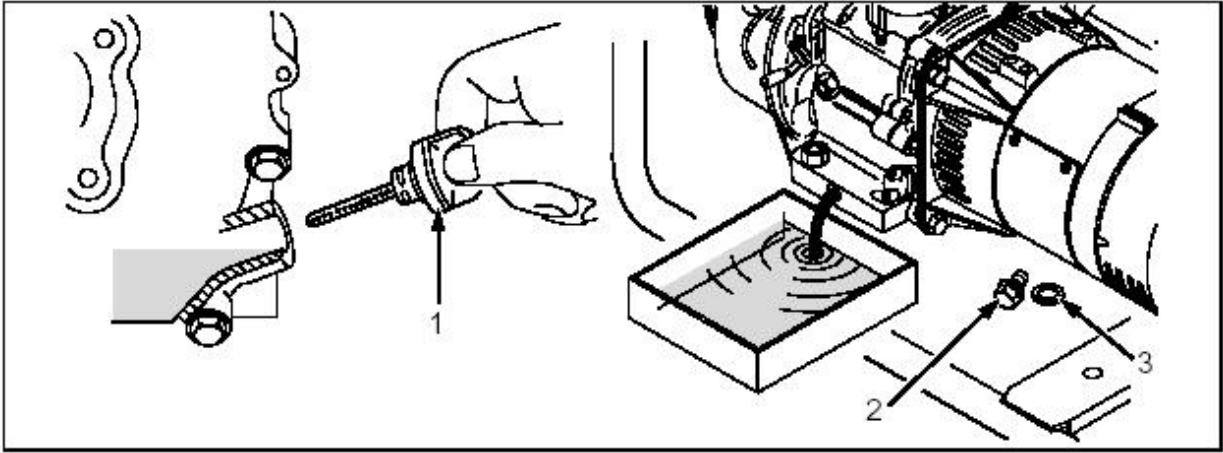

3.

!

EC2000K1

1. _____ (1) _____ (2). _____ (3)
 (4) _____ ;

2. _____ (3):

3. _____ (!) _____ (4)
 -
 ,
 -
 .
 -
 ,

4. _____ (2) _____ (5), _____ (1) _____ (3) _____ (4),

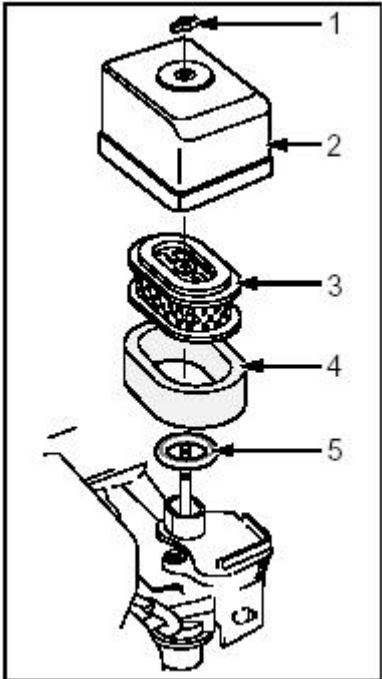

• :

1. (1) (2).
(5), (3) (4)

2. _____ (3):

3. _____ (!) _____ (4)

4. (1) (3) (4), (5), (2)

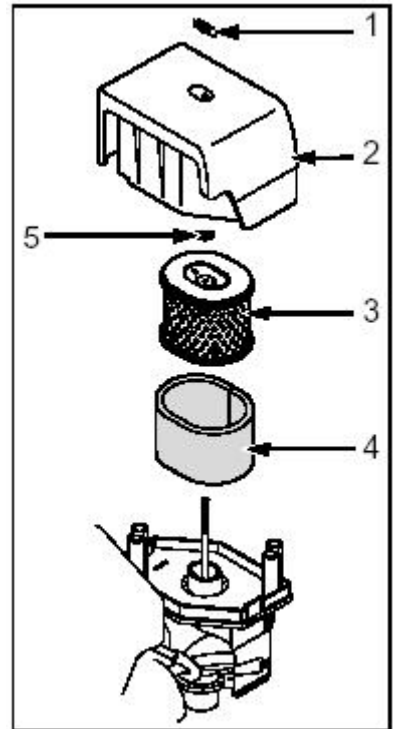

• :

4.

(1) - (2).

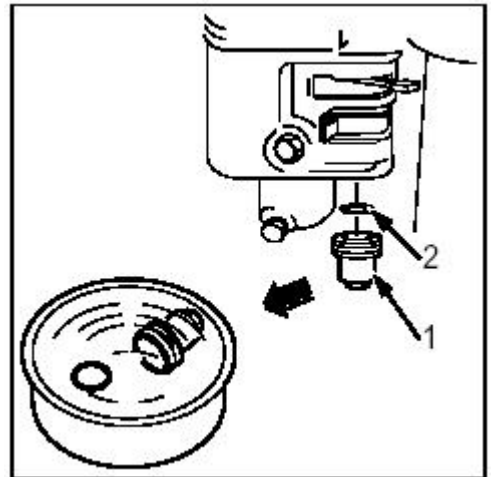

5.

:

BPR-6ES (NGK), W20EPR-U (NIPPONDENSO Co., Ltd.)

• :

•

1.

2.

3.

0,8

4.

5.

1/4-1/8

1/2

0,7

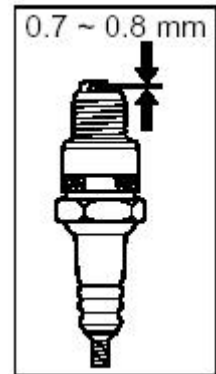

VI.

1.

! ,
“OFF”. , .

2.

1.

2.

-

(1)

-

(“ON”).

-

(2)

-

(3)

3.

4.

(-).

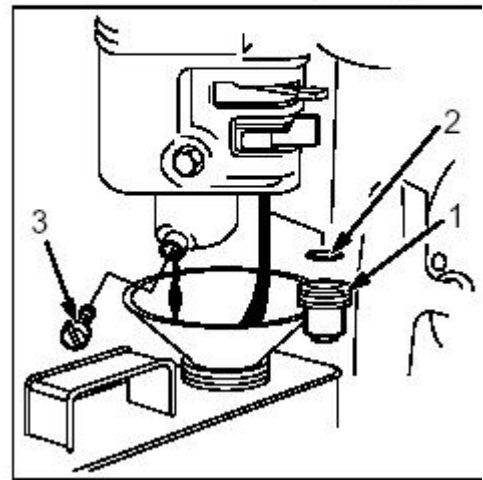

VII.

1. "OFF"
- 2.
- 3.
- 4.
- 5.

- 1.
- 2.
- 3.
- 1.
- 2.

HONDA .

VIII.

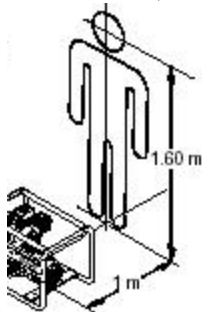
	EC2000 GV	EC3600 GV
(mm)	585 x 435 x 440	800 550 540
(kg)	35	58
(L)	3,6	6
(V)	230	
(Hz)	50	
(A)	8,7	15,5
(VA)	2000	3400
(VA)	2000	3800
(1 .)		
	86,5 db (A)	85,5 db (A)
	98 db (A)	99 db (A)
	GX160	GX270
	4	, OHV
	163 cm ³	270 cm ³
	8,5:1	8,2:1
	3000 rpm	
	0,6 L	1,1 L
	BPR-6ES (NGK), W20EPR-U (NIPPONDENSO Co., Ltd.)	

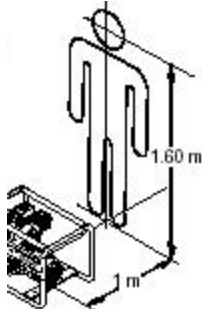
	EC5000 GV	ECT7000 GV	
(mm)	800 x 550 x 540		
(kg)	75	77	
(L)	6,5		
(V)	230	230	400
(Hz)	50		
(A)	24	20 (cos φ=1)	10 (cos φ=0,8)
(VA)	5500	4500 (cos φ=1)	6500 (cos φ=0,8)
(VA)	6000	5000 (cos φ=1)	7000 (cos φ=0,8)
(1 .)			
	88,1 db (A)		
	100 db (A)		
	GX390K1		
	4	, OHV	
	389 cm ³		
	8,0:1		
	3000 rpm		
	1,1 L		
	BPR-6ES (NGK), W20EPR-U (NIPPONDENSO Co., Ltd.)		